

Plan referred to

N

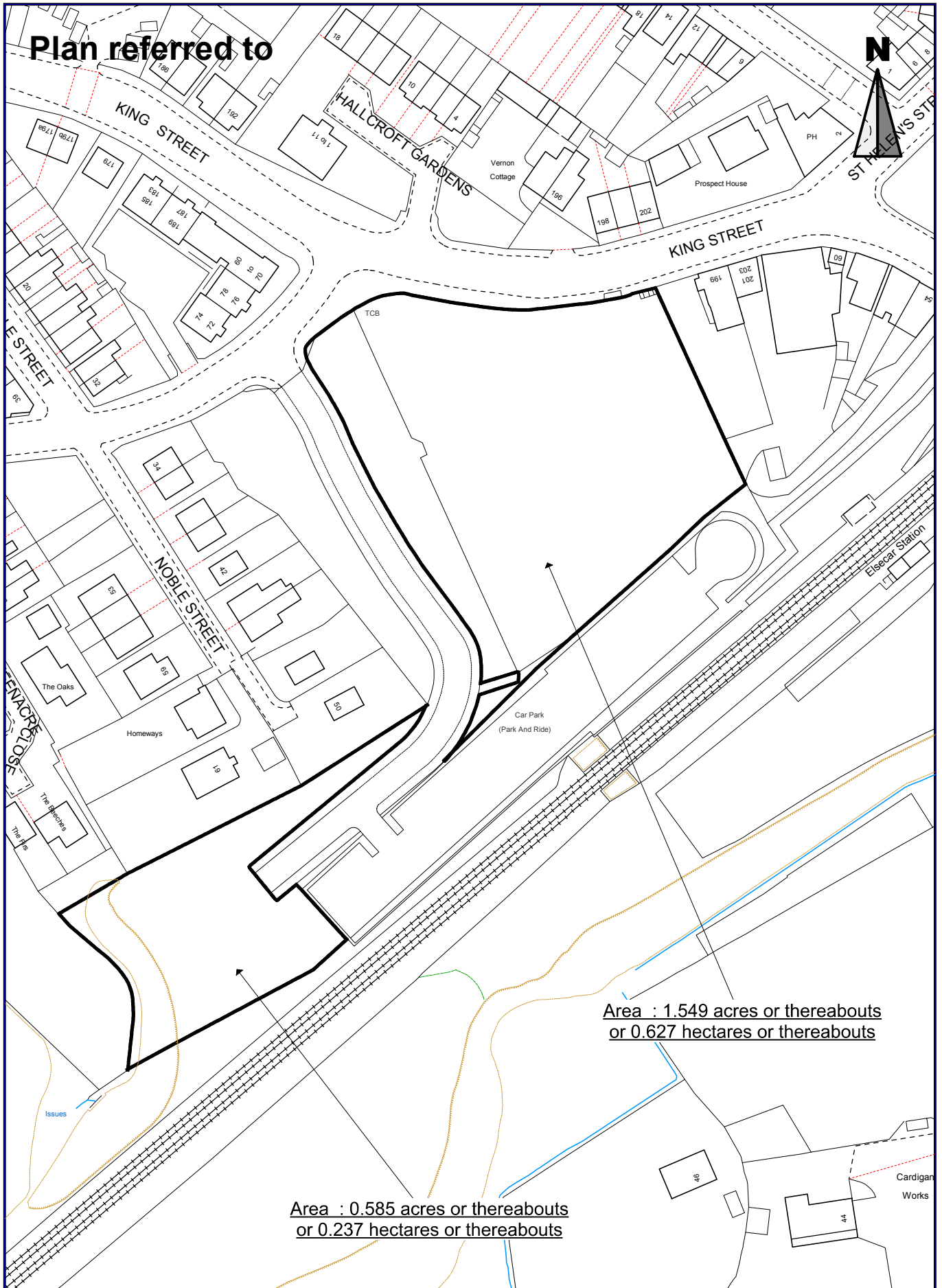

Area : 1.549 acres or thereabouts
or 0.627 hectares or thereabouts

Area : 0.585 acres or thereabouts
or 0.237 hectares or thereabouts

Reproduced from the Ordnance Survey mapping with the permission of Her Majesty's Stationery Office. © Crown Copyright. Unauthorised reproduction infringes Crown Copyright and may lead to prosecution or civil proceedings.

License number 100022264

Drwg no: SH5436D

Date: 22/08/2016

Scale 1: 1,250

Drawing Title :

ELSECAR



Strategic Property and Procurement/Asset Management
PO Box 634, Barnsley, S70 9GG

e-mail: Assetmanagement@barnsley.gov.uk
website: www.barnsley.gov.uk